

How to replace filters for 5 Stage Countertop Reverse Osmosis System

Tools needed or recommended:

- pliers
 - collet tool or tubing cutter with collet tool (recommended, but not required).
- Collet tool helps to disconnect the tubing from quick-connect (QC) fitting easier.

Disconnect the RO system from a water supply. Place the RO system on the working surface. Expect small water leakage during filter replacement, so we suggest to have some paper towel nearby.

Take 2 pictures of your RO system from front and back. In case of trouble, it helps you to check if the RO unit is assembled correctly after filter replacement.

Estimate time for replacement: 35-50 minutes.



Collet tool



Cutter with collet toll



Remove blue C-rings

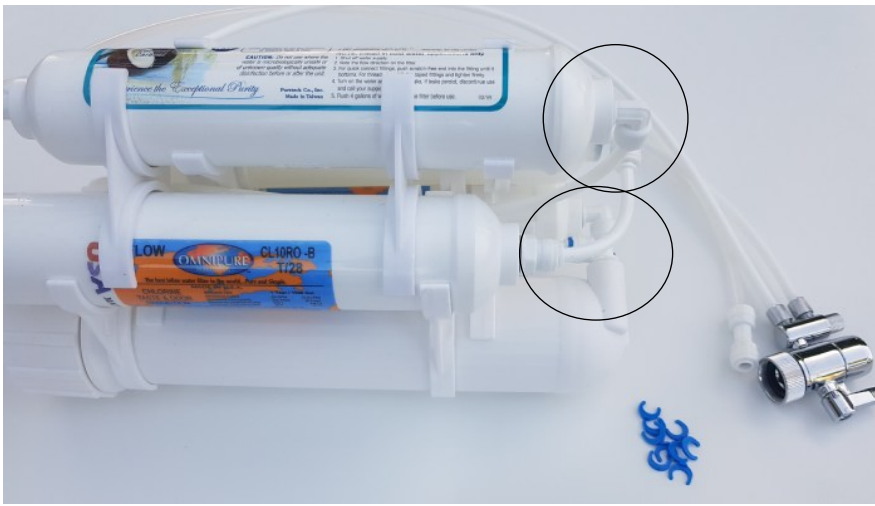

Remove blue C-rings



Remove blue C-rings

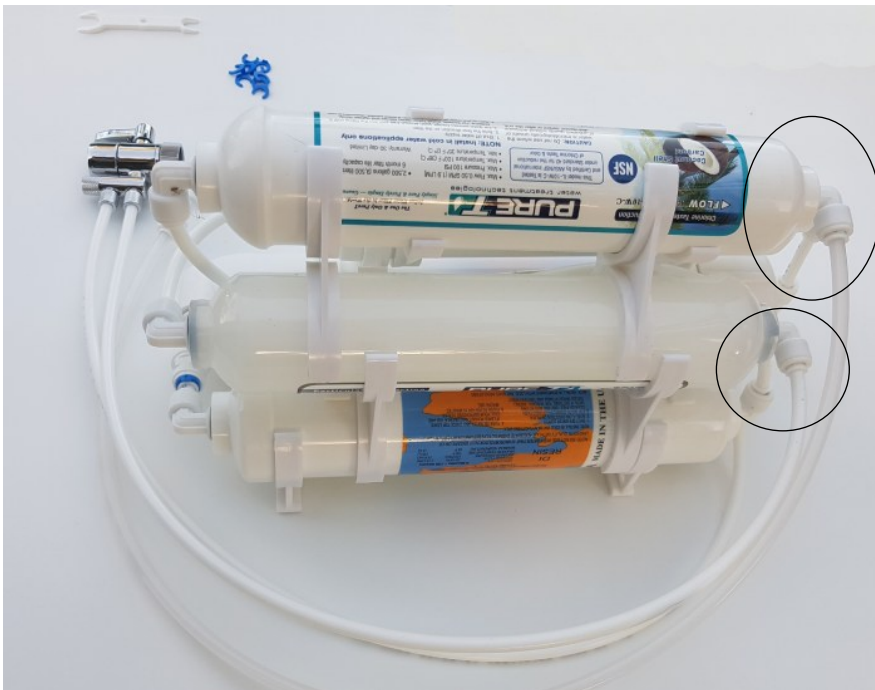

Remove blue C-rings



Lift 5th stage filter out of clips.
Tip: lift left side first.



Disconnect tubing from elbow fitting.
You can use the nail or top part of the finger to push on the collet, at the same time pull tubing out.

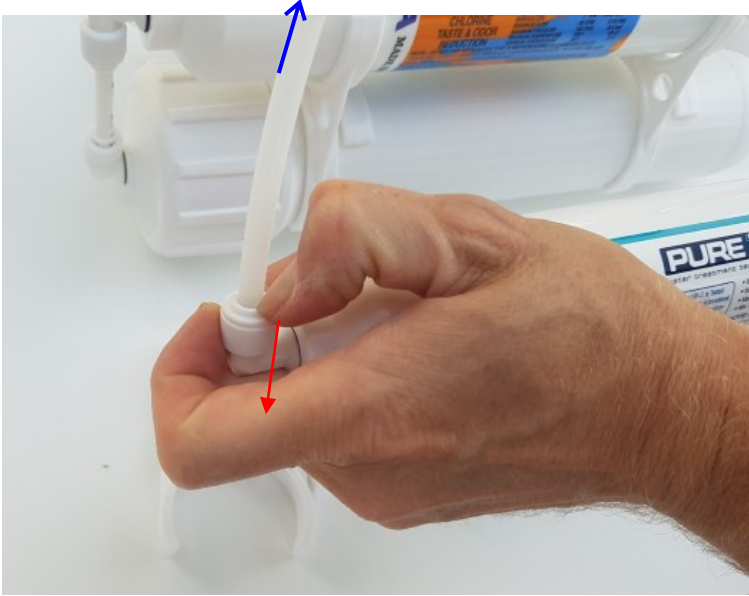

Use the collet tool to disconnect tubing.
Push the collet tool against the top part of the elbow.
Pull tubing out or hold tubing and apply pressure on the collet tool



Tip. Make sure the blue C-ring remove before disconnecting the tubing. If the blue c-ring still in place, you are not able to disconnect the tubing



Disconnect the other side of the 5th stage filter.
Remove clips.



Disconnect 1st stage (semiclear) filter.



Disconnect the other side of 1st stage (semiclear) filter.

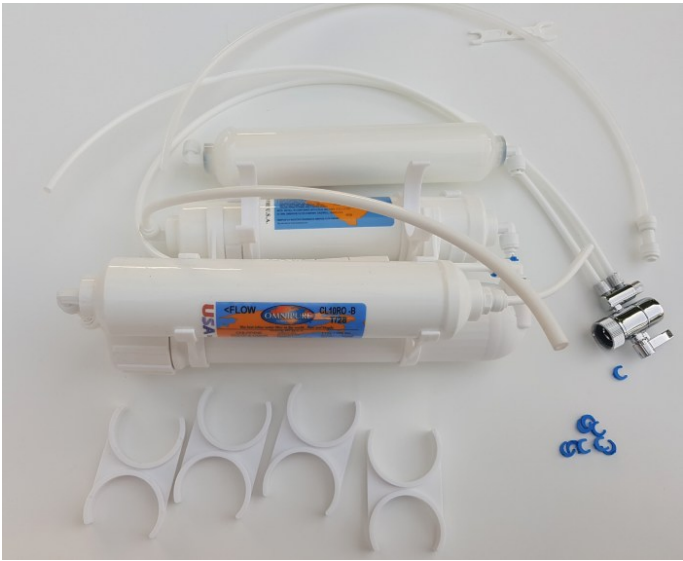

Remove 1st stage filter out of clips

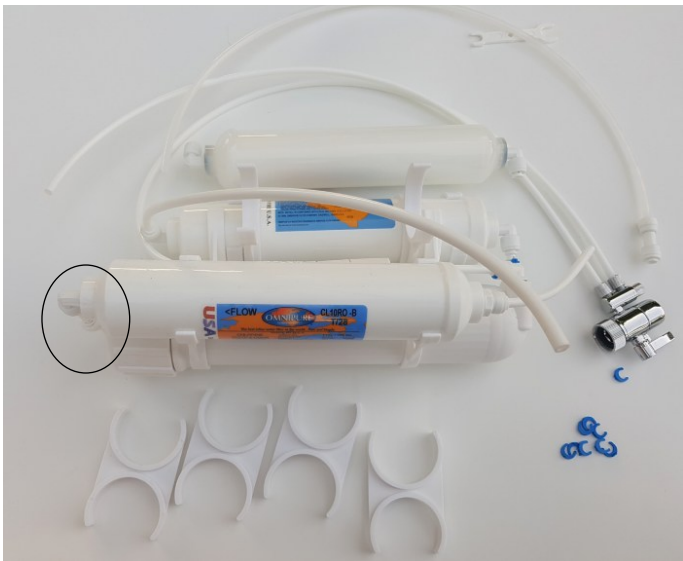

Disconnect tubing from the 2nd stage



Push on the top of elbow fitting and pull the 2nd stage filter up



Push on the top of elbow fitting and pull the 2nd stage filter up

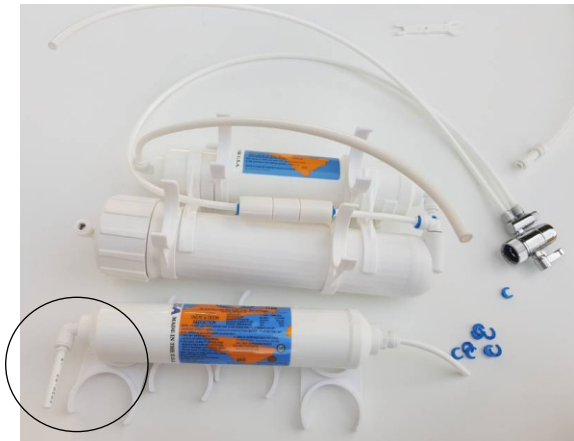

Result

Disconnect the tubing from the 2nd stage filter

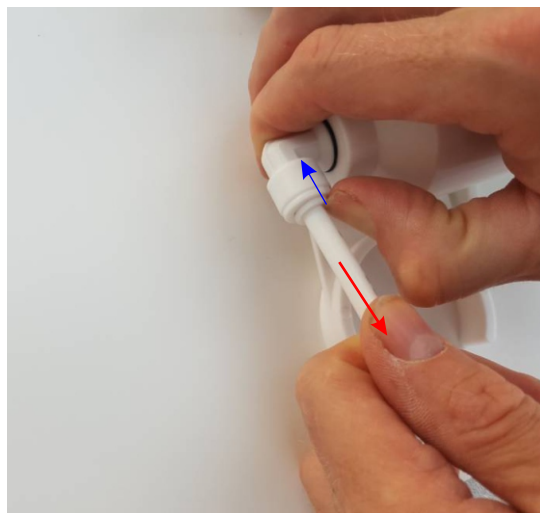

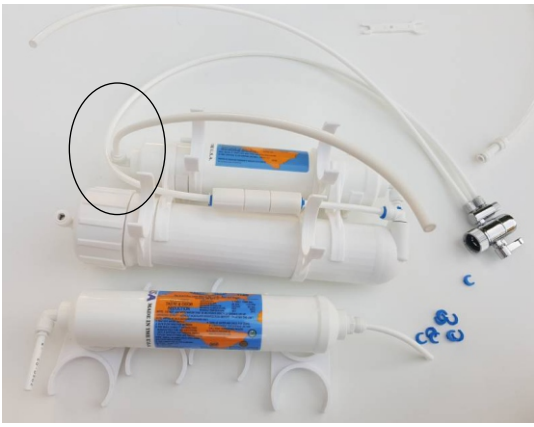

Disconnect tubing at 4th stage

Push finger against the elbow fitting, pull tubing out (second picture - if you use collect tool)



Disconnect the other side of filter. Hold membrane stage, press collect tool against elbow

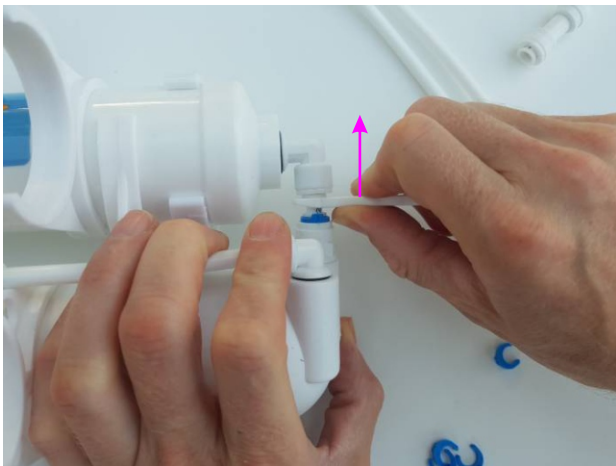

Unscrew old fitting (elbow and straight fitting) from cartridges. Before removing fitting, take another picture of filters. We recommend screw fitting to new cartridges, use the same position of elbows. Some elbows installed on filters have 180 degrees (facing opposite direction), some under 90 degrees. This will help you install new cartridges more easily.

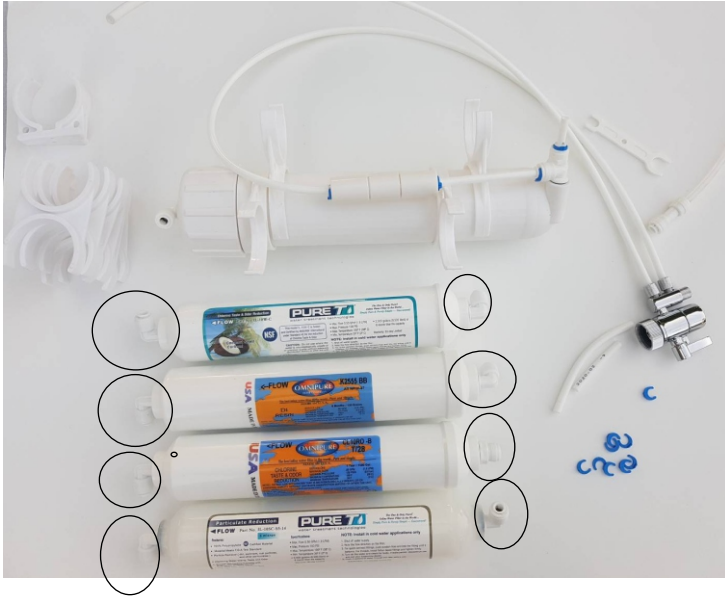

Fitting installed into new cartridges



Insert clips, place 4th stage filter toward membrane



Join cartridge and membrane housing together, make sure tubing goes all way in.



insert 2 clips (small x small)

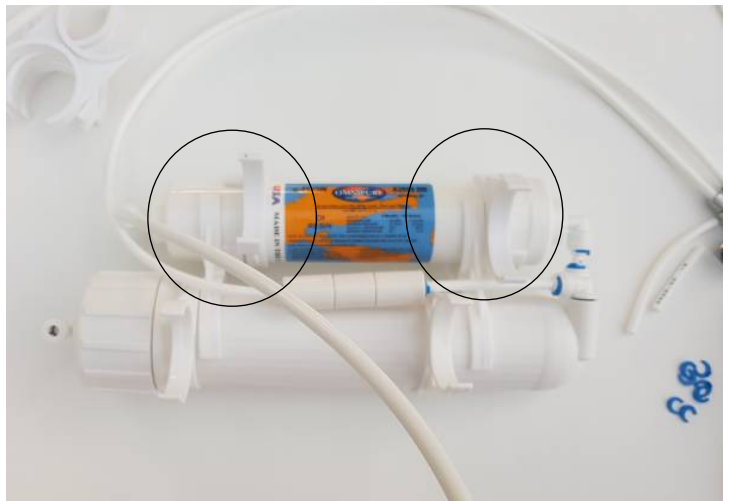

Insert the 1st stage filter and second stage filter onto clips. Connect the first stage with the diverter and second stage using tubing

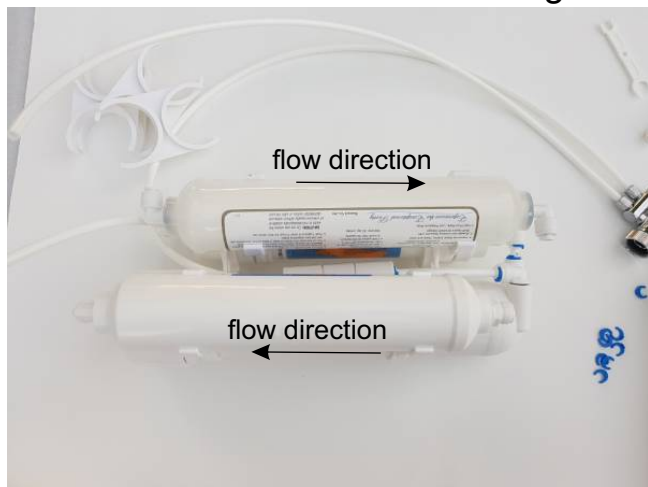

Connect the 2nd filter cartridge to the tubing



insert 4 clips (small x small)



Reconnect 4th stage and fifth stages. Insert a piece of tubing into 4th stage, that reconnects tubing with the 5th stage



Secure 5th stage cartridge into clips

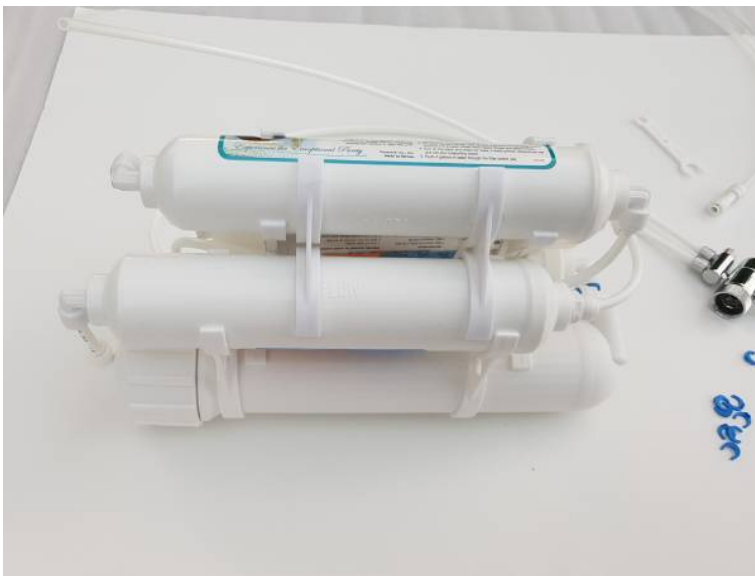

Connect Pure water line with 5th stage

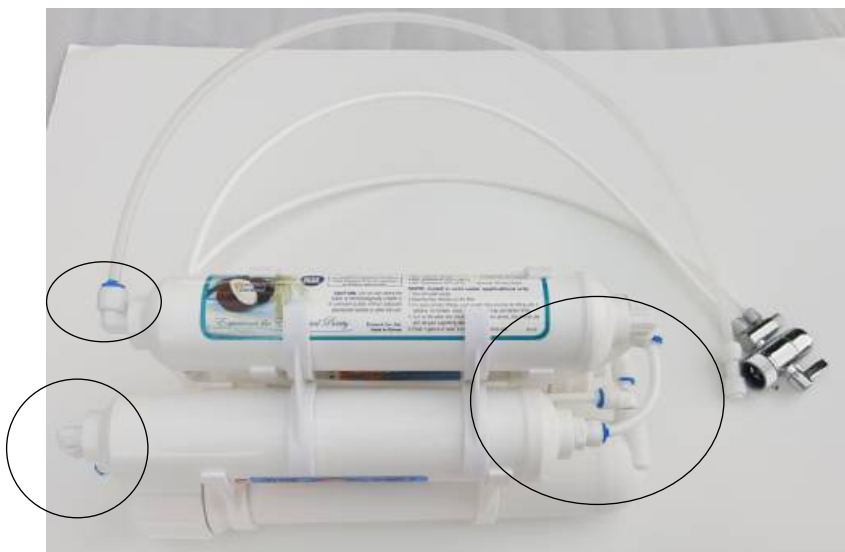

Secure all fitting with c-rings